



# HARSH ENVIRONMENTS FO CONNECTIVITY



## QUICK CONNECT SERIES BROADCAST & INDUSTRIAL ASSEMBLIES

## Deployable Fiber Optic Cable Assemblies And Cabling Systems

### Quick Connect Series (QCS)

SAMM offers a wide range pre-terminated fiber optic cable assemblies and cabling systems for industrial applications and harsh environments.

These products must be able to withstand adverse temperatures and weather conditions, shocks, vibrations, tensile stress, external pressure, corrosive surroundings, etc., which are much harsher than the environmental conditions typically endured by standard commercial connectors and cable assemblies.

These products can be pre-terminated with IP67 rated connectors to create a dust proof and waterproof point of entry into enclosures. These products provide customers with plug and play solutions for a wide range application area.

#### Harsh Environment LC Patch Cord



#### Plug Type Conversion Patch Cord

#### Receptacle Type Conversion Patch Cord

## Application Areas

- Field-deployable communications
- Industrial machine networks and controls
- Industrial/oil/gas/coal mines/refineries
- Security systems
- Security/CCTV
- Media broadcasting
- Stadium/large public venue
- Energy plants

## Key Features

- Fiber interface: Duplex LC
- Multimode and single mode
- Plug and play fiber optical cable Systems
- Fast deployment of temporary fiber optic connectivity
- Robust protection for assemblies
- Waterproof, dust-proof, and corrosion resistant
- Low cost and easy to use
- Extension with Inline
- Cable types: Mobile field and Tactical

Products Coding

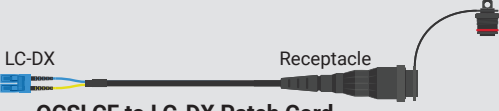
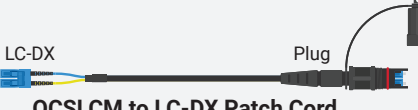
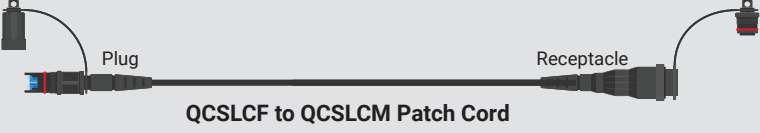
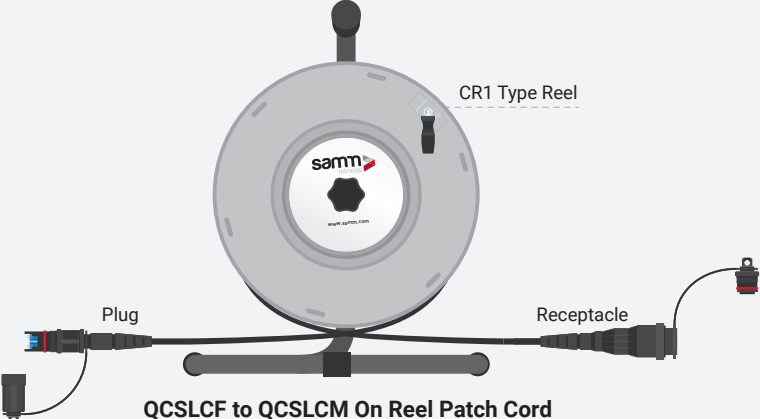
Product Illustration	Product Code
 <p>LC-DX</p> <p>Receptacle</p> <p><b>QCSLCF to LC-DX Patch Cord</b></p>	<p>QCS-PC-02-TC-056-<b>XX</b>-QCSLC<b>F</b>/ LC-DX -<b>XXX</b>M</p> <p>XX Coding: Fiber Type A1, A2, M2 ,M3 or M4</p> <p>XXX Coding: Cable Length in meters</p>
 <p>LC-DX</p> <p>Plug</p> <p><b>QCSLCM to LC-DX Patch Cord</b></p>	<p>QCS-PC-02-TC-056-<b>XX</b>-QCSLC<b>M</b>/ LC-DX -<b>XXX</b>M</p> <p>XX Coding: Fiber Type A1, A2, M2 ,M3 or M4</p> <p>XXX Coding: Cable Length in meters</p>
 <p>Plug</p> <p>Receptacle</p> <p><b>QCSLCF to QCSLCM Patch Cord</b></p>	<p>QCS-PC-02-TC-056-<b>XX</b>-QCSLC<b>M</b>/ QCSLC<b>F</b>-<b>XXX</b>M</p> <p>XX Coding: Fiber Type A1, A2, M2 ,M3 or M4</p> <p>XXX Coding: Cable Length in meters</p>
 <p>CR1 Type Reel</p> <p>Plug</p> <p>Receptacle</p> <p><b>QCSLCF to QCSLCM On Reel Patch Cord</b></p>	<p>QCS-CR1PC-02-TC-056-<b>XX</b>-QCSLC<b>M</b>/ QCSLC<b>F</b>-<b>XXX</b>M</p> <p>XX Coding: Fiber Type A1, A2, M2 ,M3 or M4</p> <p>XXX Coding: Cable Length in meters</p>

Application Examples

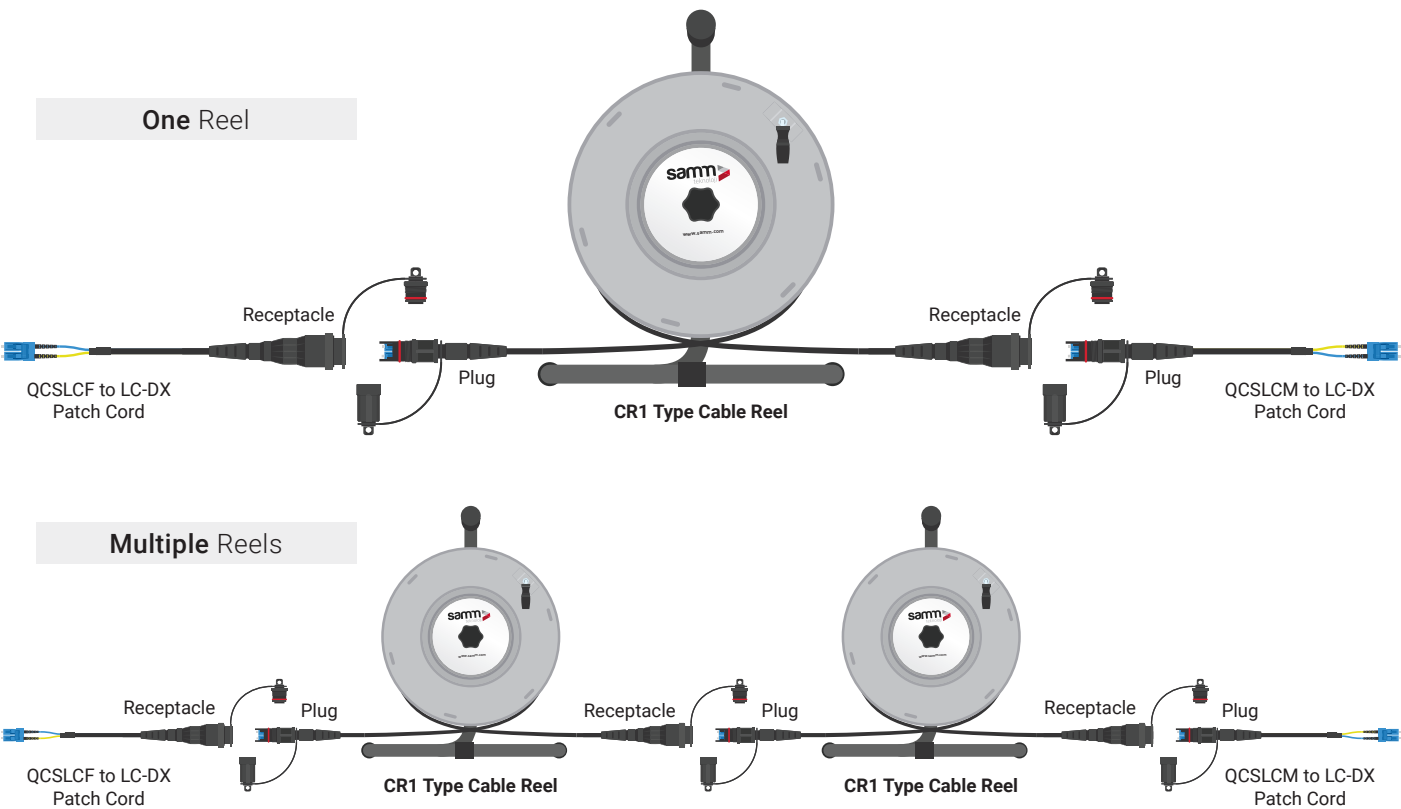

Ruggedised PUR Jacket Distribution Cable | 2 Fibers

Design Type **UT-WT9Q(ZN-AY)11Y**

Standards: IEC 60794-1 / IEC 60794-3 / IEC 60793-1

Cable Construction

1	Fiber	Single-mode or Multi-mode 245 μ
2	Tight Buffer Tube	900μ TPE
3	Strength Member	Water Blocking Swellable Aramid yarn
4	Outer Jacket	TPU

Properties

High tensile strength with improved crush resistance
For direct connector assembly and easy stripping
Excellent coiling capability for Suitable for military tactical field use
High chemical resistance against acids and alkalies
For high mechanical and thermal stability
Metal free, halogen free and non-corrosive fire gases
UV-protected, outdoor use, and high abrasion and cut resistance

Mechanical Properties

Test	Test Standard	Specified Value
Tensile Force	IEC 60794-1-21-E1	1800 N (Installation), 600 N (In Service)
Crush Resistance	IEC 60794-1-21-E3	4400 N / 10 cm (Installation), 2000 N / 10 cm (In Service)
Impact	IEC 60794-1-21-E4	Wp=10J, R:30cm, 3 impacts
Repeated Bending	IEC 60794-1-21-E6	R= 20 x D, 25 cycles
Torsion	IEC 60794-1-21-E7	L:1 m, ±180°, 5 cycles
Cable Bending	IEC 60794-1-21-E11A	R= 20 x D, 4 turns, 3 cycles

Environmental Properties

Property	Conditions	Test Standard	Result / Value
Temperature Range	-	IEC 60794-1-22-F12	-5 to +50°C (Installation), -25 to +60 °C (In Service), -40 to +60 °C (Storage)
Water Penetration	3m specimen,1m water altitude	IEC 60794-1-2-F5B	No leakage in 24 hours
Fire Propagation	Vertical single cable	IEC 60332-1-2	passed
Smoke Density	-	IEC 61034-2	passed
Halogen Acid Gas	Jacket material	IEC 60754-1	passed
Degree of Acidity	Jacket material	IEC 60754-2	passed
2011/65/EC (RoHS)	-	-	compliant
(EU) No 305/2011 (CPR)	-	EN 50575	Eca

Ordering Codes

Order Code	Fiber Count	Sub Unit Count	Tube Diameter (mm) nom.	Cable Diameter (mm) nom.	Cable Weight (kg) nom.
002F-UT-WT9Q(ZN-AY)11Y-4U090-1x2-...-Eca-1.8kN	4	4	0.9	5.6	25

\* Available fiber types are G657.A1, G657.A2, G651.OM2, G651.OM3, G651.OM4

\* Sample Code: 004F-UT-WT9Q(ZN-AY)11Y-4U090-1x4-A1-BK-Eca-1.8kN

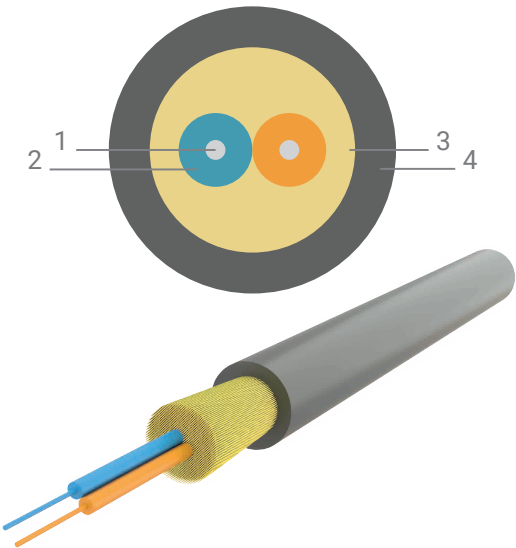
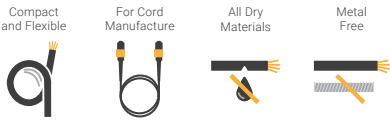

## Portable Field Deployable Fiber Optic Cable Reel

This tactical portable cable reel is made of metal and has an embedded stand, a crank and a brake screw. The portable cable reel is suitable for fiber optic and copper cables and it is designed for field, military and tactical applications, where quick cable deployment is essential.

### Features

Made of Steel that is both light and strong.
Stackable Frame Design
Double flange for easy access to the inner end
Foldable Crank handle
Central brake knob to prevent unwanted rotation
Integrated carrying and unwinding stand
Stand protection feet to prevent damage from the surface

### Reel Capacity

Cable Capacity	Cable Diameter
200 m	5.6 mm
300 m	4.8 mm

### Reel Specifications

Model Number	Reel Weight
MT02698	12 kg

### Dimensions



Unit: mm

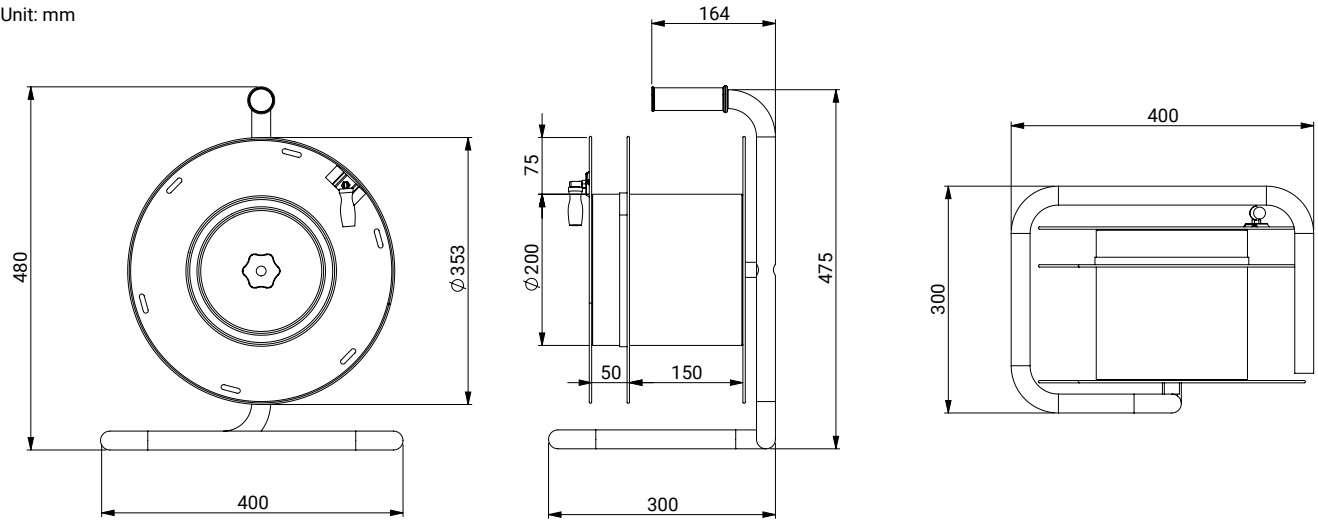

Standard Ordering Codes

QCSLC to LC-DX Assemblies

Product Code	Item Coding	Item Description
MT17144	QCS-PC-02-TC-056-A2-QCSLCF/ LC-DX-001M	CABLE ASS'Y, SINGLE MODE A2, QCS-LC RECEPTACLE TO LCDX_1.0 meter
MT17145	QCS-PC-02-TC-056-A2-QCSLCF/ LC-DX-002M	CABLE ASS'Y, SINGLE MODE A2, QCS-LC RECEPTACLE TO LCDX_2.0 meters
MT17146	QCS-PC-02-TC-056-A2-QCSLCF/ LC-DX-003M	CABLE ASS'Y, SINGLE MODE A2, QCS-LC RECEPTACLE TO LCDX_3.0 meters
MT17147	QCS-PC-02-TC-056-A2-QCSLCF/ LC-DX-005M	CABLE ASS'Y, SINGLE MODE A2, QCS-LC RECEPTACLE TO LCDX_5.0 meters
MT17148	QCS-PC-02-TC-056-M3-QCSLCF/ LC-DX-001M	CABLE ASS'Y, MULTI MODE OM3, QCS-LC RECEPTACLE TO LCDX_1.0 meter
MT17149	QCS-PC-02-TC-056-M3-QCSLCF/ LC-DX-002M	CABLE ASS'Y, MULTI MODE OM3, QCS-LC RECEPTACLE TO LCDX_2.0 meters
MT17150	QCS-PC-02-TC-056-M3-QCSLCF/ LC-DX-003M	CABLE ASS'Y, MULTI MODE OM3, QCS-LC RECEPTACLE TO LCDX_3.0 meters
MT17151	QCS-PC-02-TC-056-M3-QCSLCF/ LC-DX-005M	CABLE ASS'Y, MULTI MODE OM3, QCS-LC RECEPTACLE TO LCDX_5.0 meters
MT17152	QCS-PC-02-TC-056-A2-QCSLCM/ LC-DX-001M	CABLE ASS'Y, SINGLE MODE A2, QCS-LC PLUG TO LCDX_1.0 meter
MT17153	QCS-PC-02-TC-056-A2-QCSLCM/ LC-DX-002M	CABLE ASS'Y, SINGLE MODE A2, QCS-LC PLUG TO LCDX_2.0 meters
MT17154	QCS-PC-02-TC-056-A2-QCSLCM/ LC-DX-003M	CABLE ASS'Y, SINGLE MODE A2, QCS-LC PLUG TO LCDX_3.0 meters
MT17155	QCS-PC-02-TC-056-A2-QCSLCM/ LC-DX-005M	CABLE ASS'Y, SINGLE MODE A2, QCS-LC PLUG TO LCDX_5.0 meters
MT17156	QCS-PC-02-TC-056-M3-QCSLCM/ LC-DX-001M	CABLE ASS'Y, MULTI MODE OM3, QCS-LC PLUG TO LCDX_1.0 meter
MT17157	QCS-PC-02-TC-056-M3-QCSLCM/ LC-DX-002M	CABLE ASS'Y, MULTI MODE OM3, QCS-LC PLUG TO LCDX_2.0 meters
MT17158	QCS-PC-02-TC-056-M3-QCSLCM/ LC-DX-003M	CABLE ASS'Y, MULTI MODE OM3, QCS-LC PLUG TO LCDX_3.0 meters
MT17159	QCS-PC-02-TC-056-M3-QCSLCM/ LC-DX-005M	CABLE ASS'Y, MULTI MODE OM3, QCS-LC PLUG TO LCDX_5.0 meters

QCSLC Male to QCSLC Female Assemblies

Product Code	Item Coding	Item Description
MT17160	QCS-PC-02-TC-056-A2-QCSLCM/ QCSLCF-010M	CABLE ASS'Y, SINGLE MODE A2, QCS-LC PLUG TO QCS-LC RECEPTACLE_10.0 meter
MT17161	QCS-PC-02-TC-056-A2-QCSLCM/ QCSLCF-020M	CABLE ASS'Y, SINGLE MODE A2, QCS-LC PLUG TO QCS-LC RECEPTACLE_20.0 meters
MT17162	QCS-PC-02-TC-056-A2-QCSLCM/ QCSLCF-030M	CABLE ASS'Y, SINGLE MODE A2, QCS-LC PLUG TO QCS-LC RECEPTACLE_30.0 meters
MT17163	QCS-PC-02-TC-056-A2-QCSLCM/ QCSLCF-050M	CABLE ASS'Y, SINGLE MODE A2, QCS-LC PLUG TO QCS-LC RECEPTACLE_50.0 meters
MT17164	QCS-PC-02-TC-056-M3-QCSLCM/ QCSLCF-010M	CABLE ASS'Y, MULTI MODE OM3, QCS-LC PLUG TO QCS-LC RECEPTACLE_10.0 meter
MT17165	QCS-PC-02-TC-056-M3-QCSLCM/ QCSLCF-020M	CABLE ASS'Y, MULTI MODE OM3, QCS-LC PLUG TO QCS-LC RECEPTACLE_20.0 meters
MT17166	QCS-PC-02-TC-056-M3-QCSLCM/ QCSLCF-030M	CABLE ASS'Y, MULTI MODE OM3, QCS-LC PLUG TO QCS-LC RECEPTACLE_30.0 meters
MT17167	QCS-PC-02-TC-056-M3-QCSLCM/ QCSLCF-050M	CABLE ASS'Y, MULTI MODE OM3, QCS-LC PLUG TO QCS-LC RECEPTACLE_50.0 meters

On Reel Assemblies

Product Code	Item Coding	Item Description
MT17168	QCS-CR1PC-02-TC-056-A2-QCSLCM/ QCSLCF-100M	ON REEL CABLE ASS'Y, SINGLE MODE A2, QCS-LC PLUG TO QCS-LC RECEPTACLE_100.0 meter
MT17169	QCS-CR1PC-02-TC-056-A2-QCSLCM/ QCSLCF-150M	ON REEL CABLE ASS'Y, SINGLE MODE A2, QCS-LC PLUG TO QCS-LC RECEPTACLE_150.0 meters
MT17170	QCS-CR1PC-02-TC-056-A2-QCSLCM/ QCSLCF-200M	ON REEL CABLE ASS'Y, SINGLE MODE A2, QCS-LC PLUG TO QCS-LC RECEPTACLE_200.0 meters
MT17171	QCS-CR1PC-02-TC-056-M3-QCSLCM/ QCSLCF-100M	ON REEL CABLE ASS'Y, MULTI MODE OM3, QCS-LC PLUG TO QCS-LC RECEPTACLE_100.0 meter
MT17172	QCS-CR1PC-02-TC-056-M3-QCSLCM/ QCSLCF-150M	ON REEL CABLE ASS'Y, MULTI MODE OM3, QCS-LC PLUG TO QCS-LC RECEPTACLE_150.0 meters
MT17173	QCS-CR1PC-02-TC-056-M3-QCSLCM/ QCSLCF-200M	ON REEL CABLE ASS'Y, MULTI MODE OM3, QCS-LC PLUG TO QCS-LC RECEPTACLE_200.0 meters



[telecom.samm.com/create-account](https://telecom.samm.com/create-account)

Create an account to receive our  
news, updates and discounts.

SAMM Teknoloji İletişim San. ve Tic. A.Ş.



## TURKIYE

### Company

SAMM Teknoloji İletişim San. ve Tic. A.Ş.

### Address

GOSB İhsandede Cd. 800. Sok No: 802,  
41400 Gebze-Kocaeli, Türkiye

### Telephone

+90 444 1 726 / +90 (262) 677 16 80  
(Fax) +90 (262) 677 16 81

### Email

info@samm.com



## GERMANY

### Company

SAMM GmbH

### Address

Niederstraße 18  
40789 Monheim/Deutschland

### Telephone

+49 176 814 655 76  
+49 176 814 655 84

### Email

de@samm.com

## Telecom Group

### Website

telecom.samm.com

### Email

telecom@samm.com



Our Website

